

# Installation Guide (For BKT-562)

BKT-562

**Important Notes:**

All LCD Monitor / TV brackets are thoroughly inspected and fully tested operational in factory. We accept no liability whatsoever for any losses due to improper operation, or any unauthorized alternation. All trademarks contained in this installation guide are the property of their respective owners.

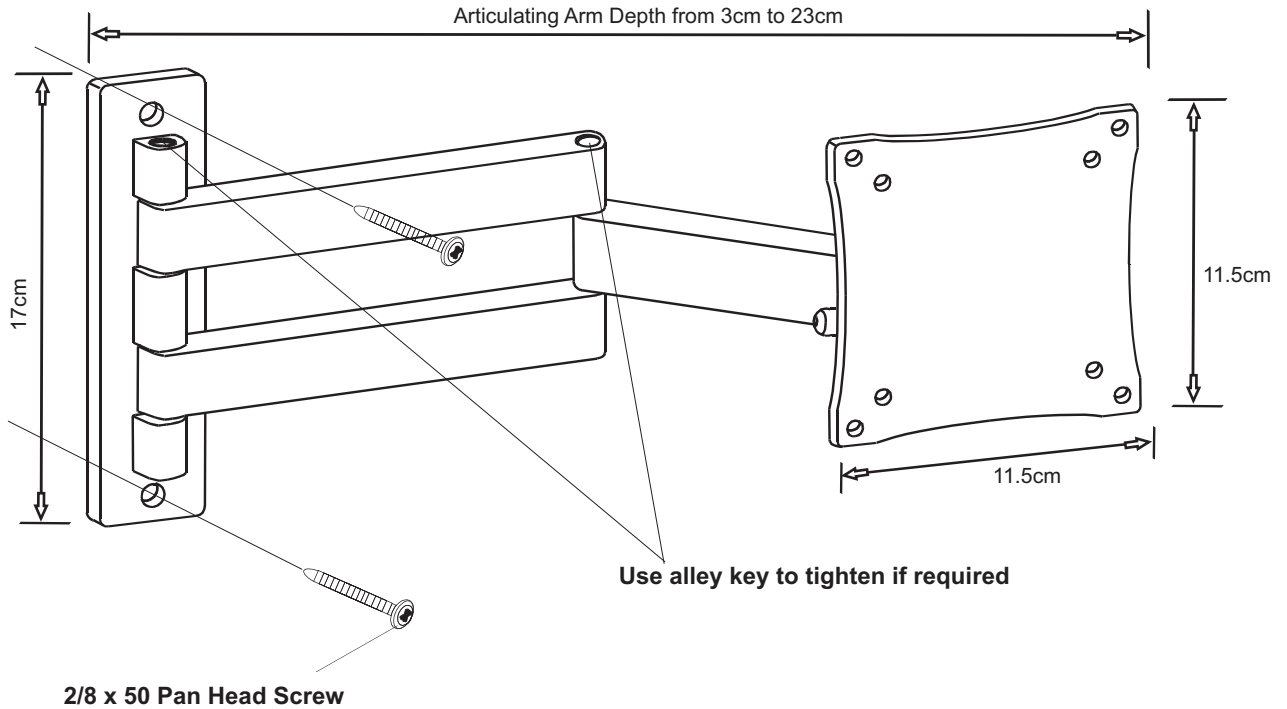

\*\* Complied to VESA 75mm and 100mm standard mounting sizes

**Accessories for mounting BKT-562 to LCD Monitor / TV:**

- 2/8 x 50 Pan Head Screws (2 nos.)
- M5 x 14 Pan Head Screws (4 nos.)
- M5 x 10 Pan Head Screws (4 nos.)
- M4 x 14 Pan Head Screws (4 nos.)
- M4 x 10 Hex Head Screws (4 nos.)

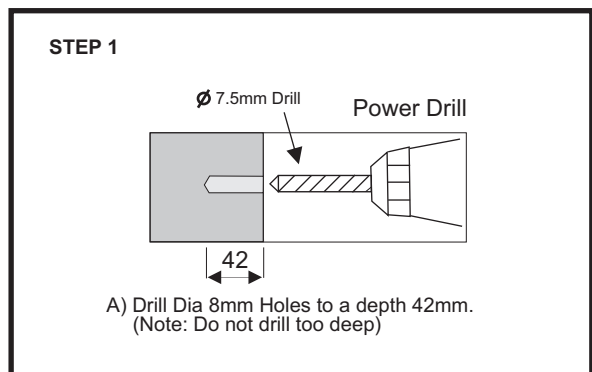

**End**