

Installation Guide (PLT-412)

V: 10.0

PLT

Important Notice: Do not turn on power to the projector lift until it is completely installed on the ceiling.

Warning: Caution with main supply and live wires. Install with qualified technician or trained personnel.

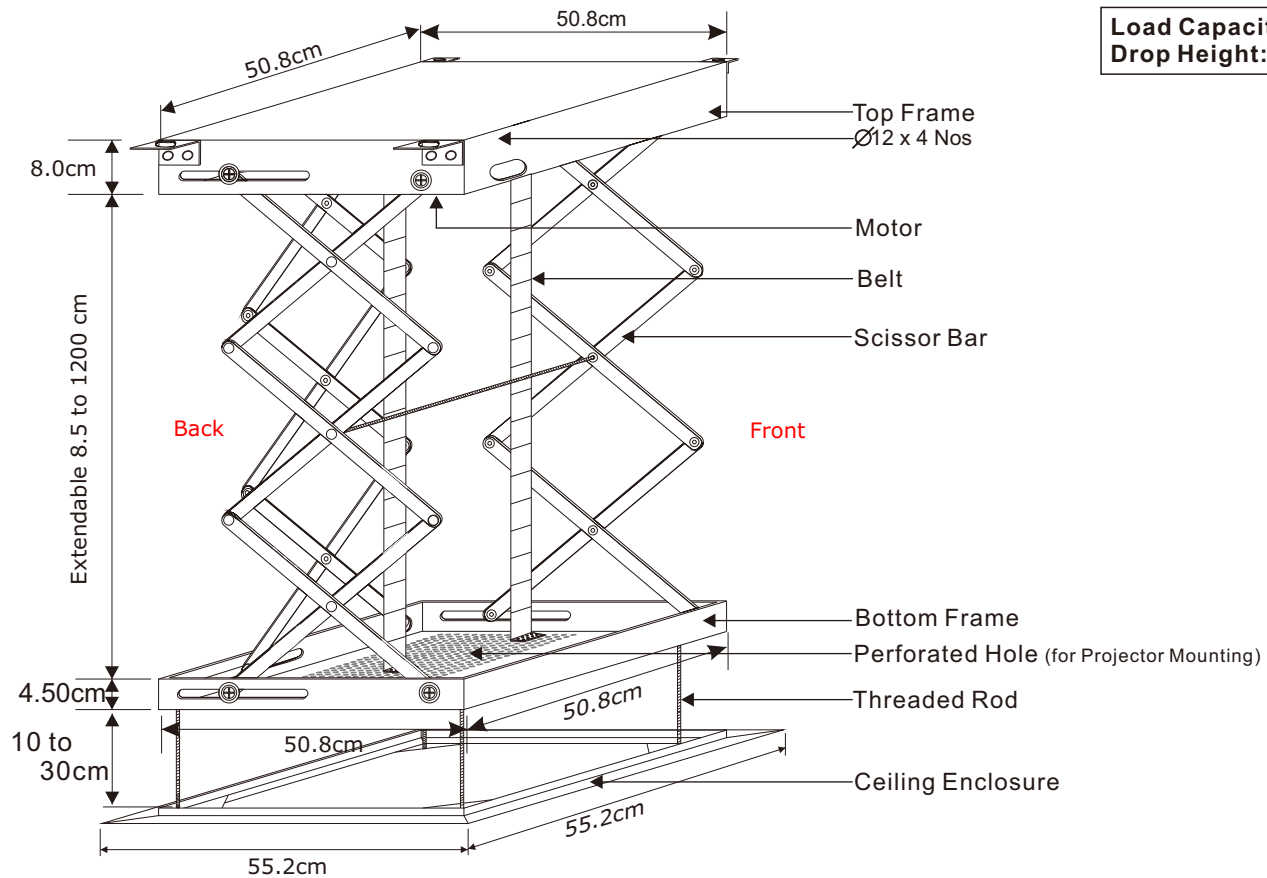

Types of Installation Mounts

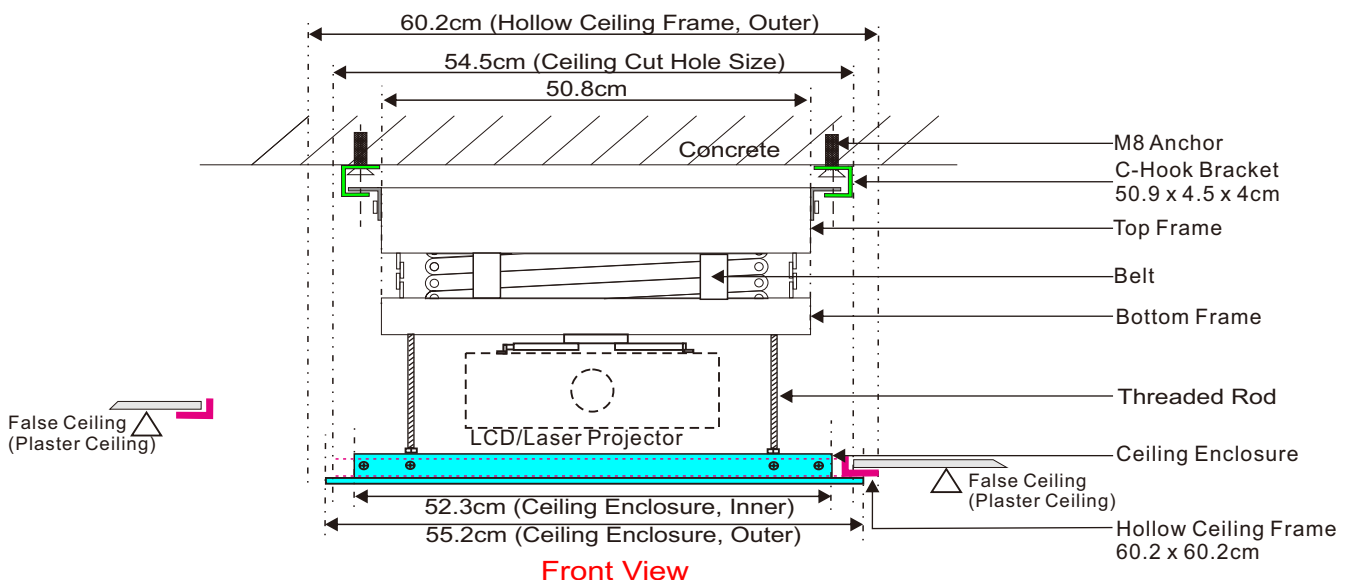
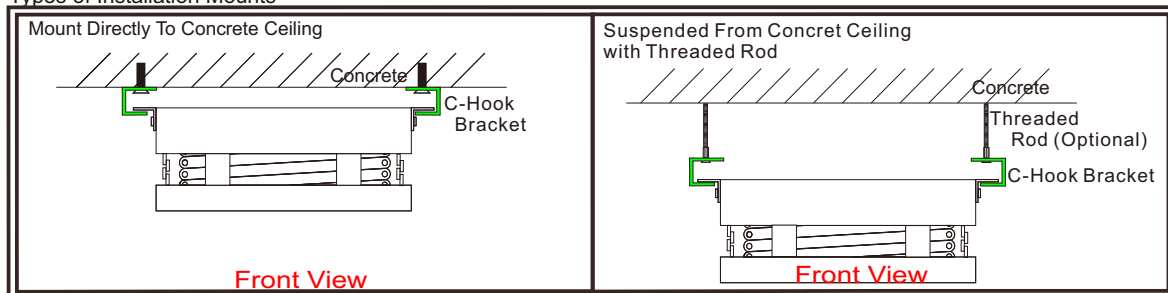

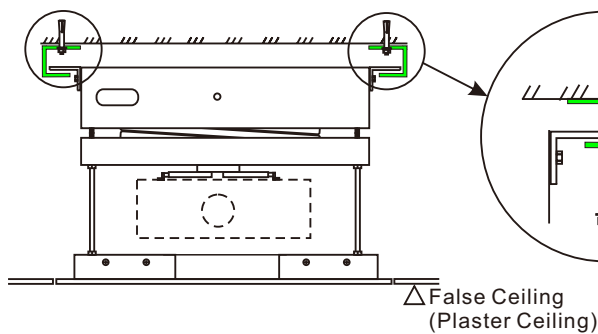
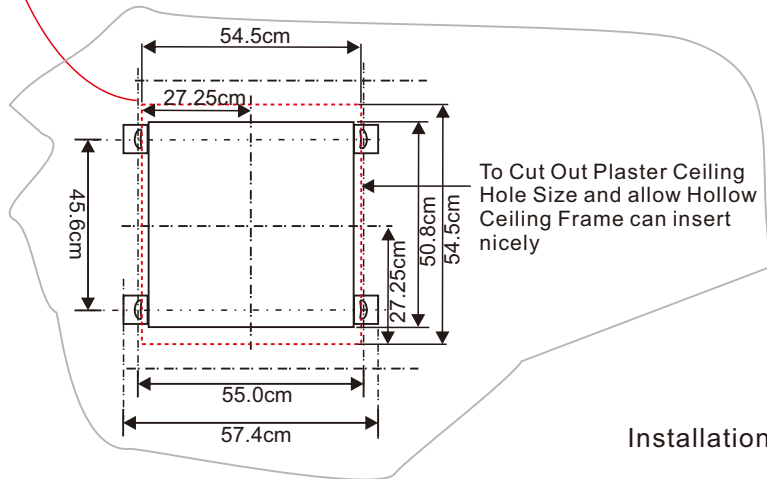
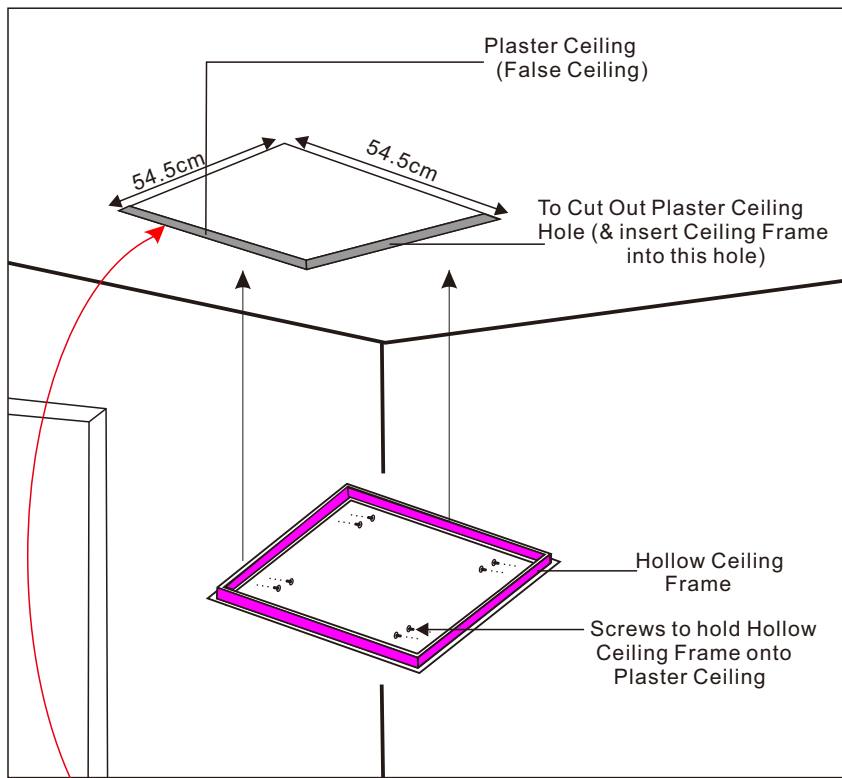

Step 1

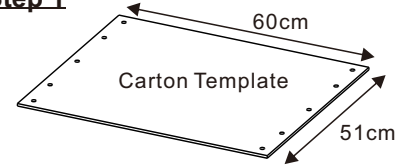

Carton Paper Template for Ease of Marking Hole Position.

Step 2

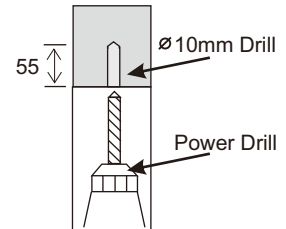

Drill Dia. 10mm holes to a depth of 55mm.
(Note: Do not drill too deep)

Step 3

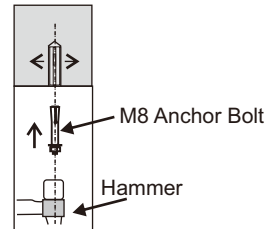

Insert M8 anchor into the hole.
Use pin punch to expand the anchor.

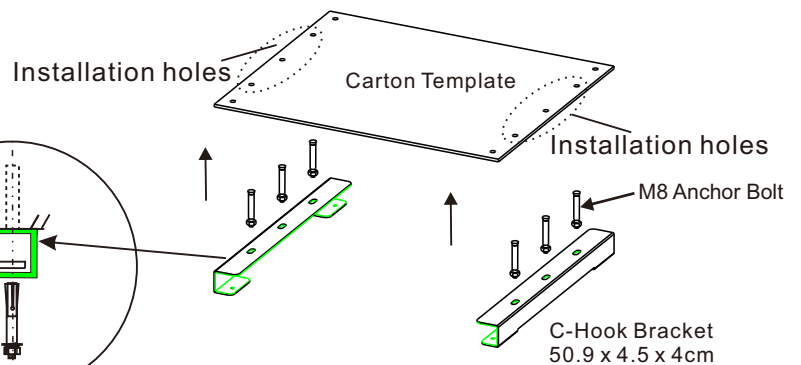

Step 4

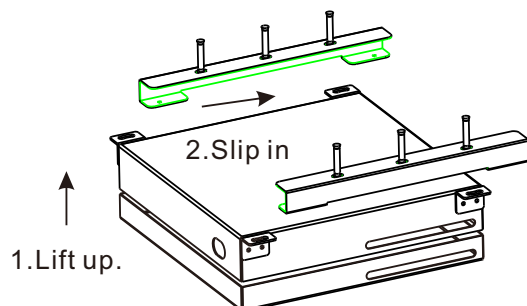

Step 5

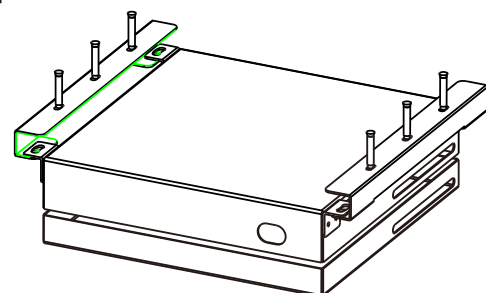

Step 6

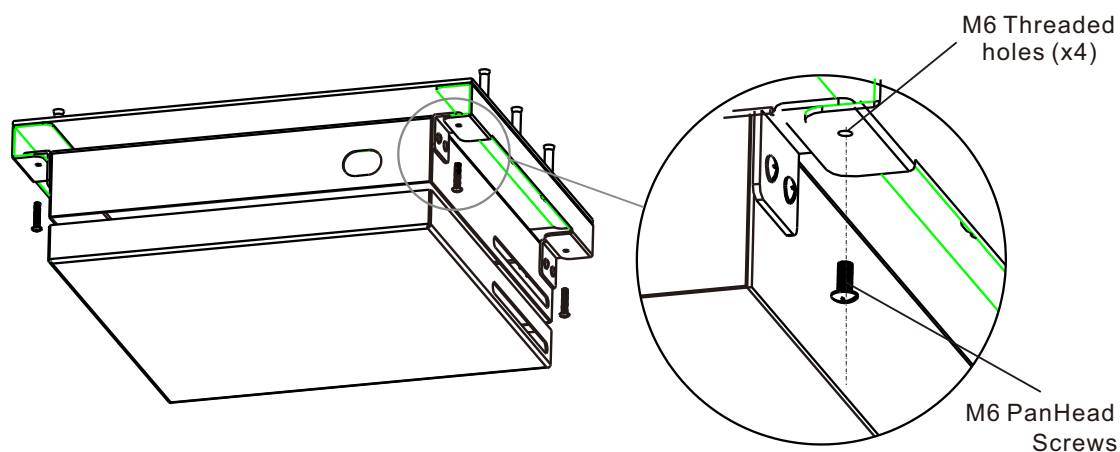

Step 7

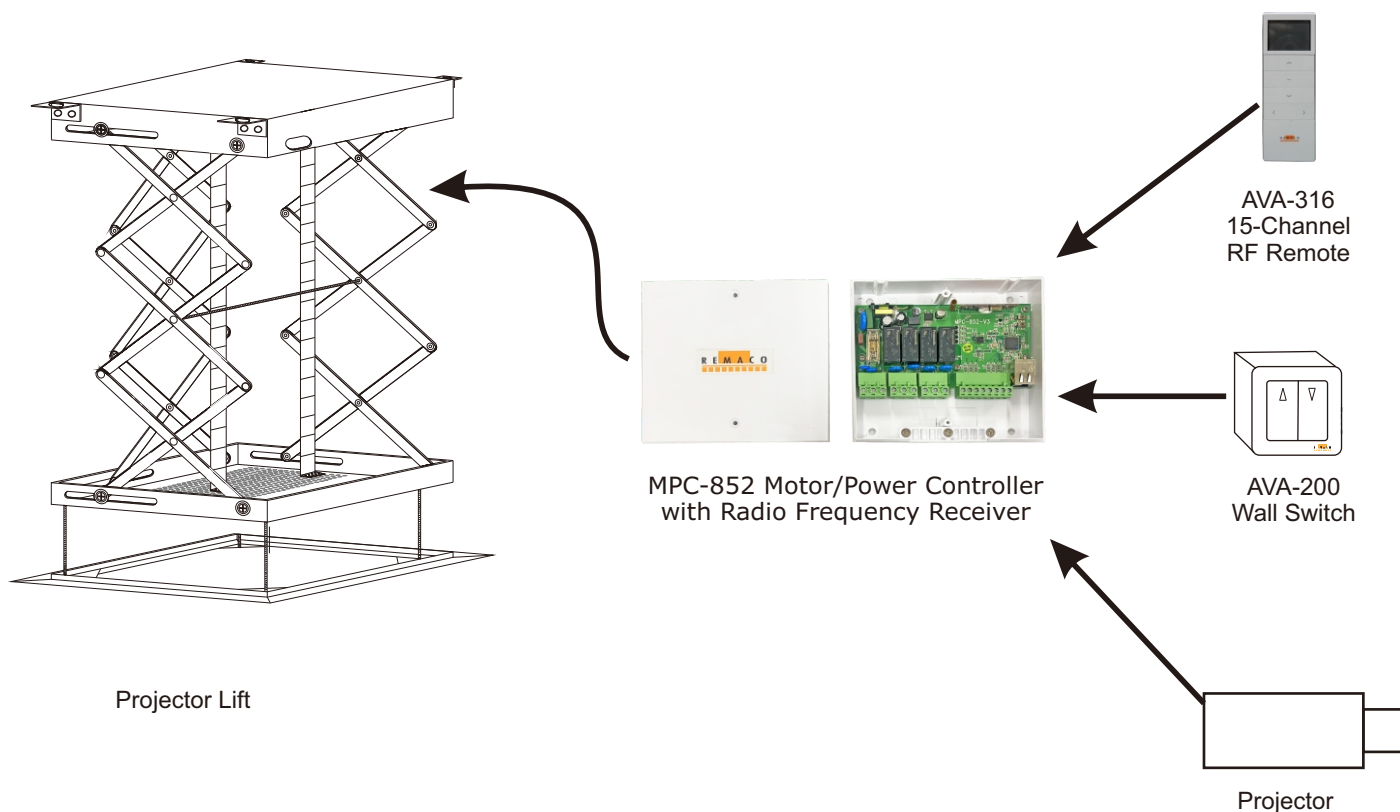

⚠ Connection of all cables to the MPC-852 (Refer to Installation Guide of MPC-852)

Step 8

Upper Limit (no need adjust unless required)

" - " move away from top frame
 " + " move closer to top frame

Lower Limit

" - " less drop (close to top frame)
 " + " more drop (away from top frame)

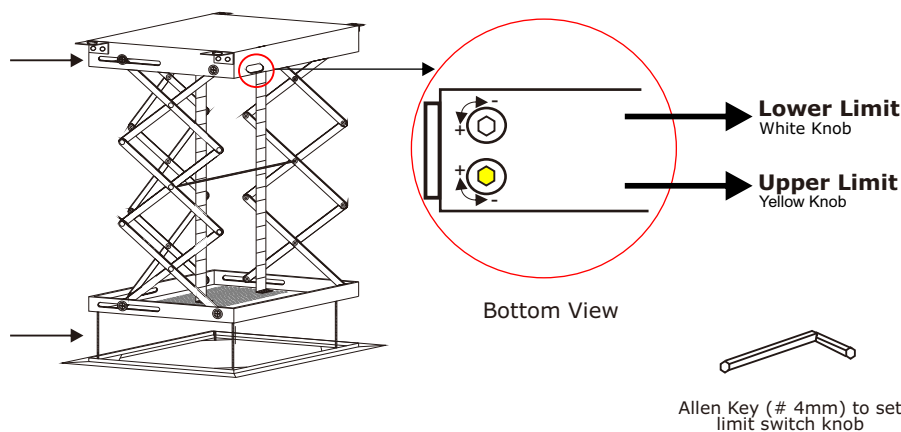

Important Note

Do not adjust the Upper Limit of the lift higher than the original factory preset position. If adjusted, the lift will move into the frame and be stopped by force and not the Upper Limit Switch. This will cause overheating of the motor, rendering the lift to being unable to operate properly.

Step 9

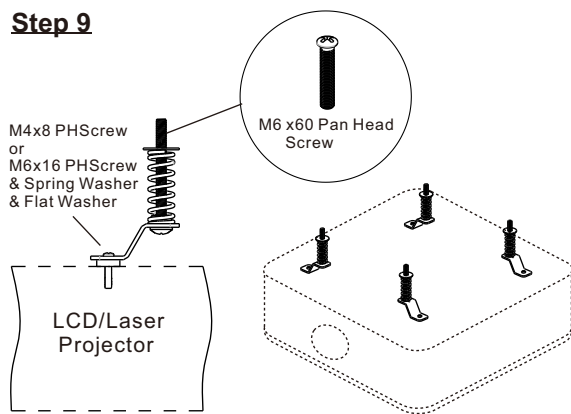

Step 10

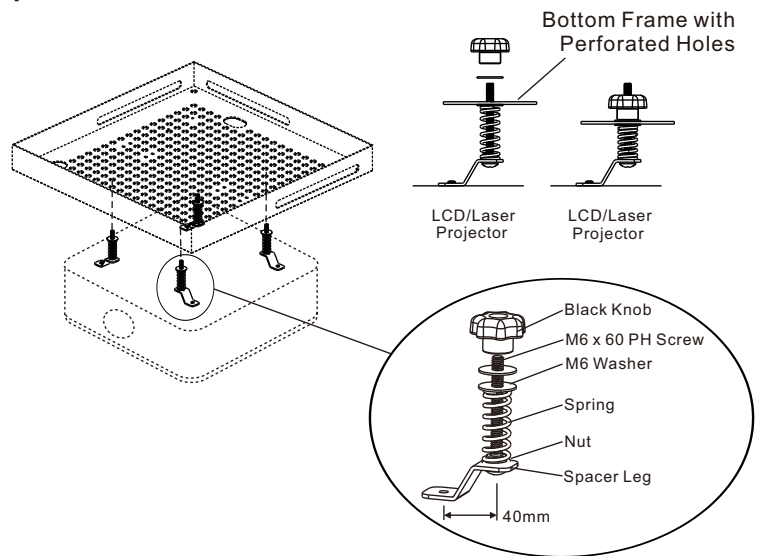

Step 13

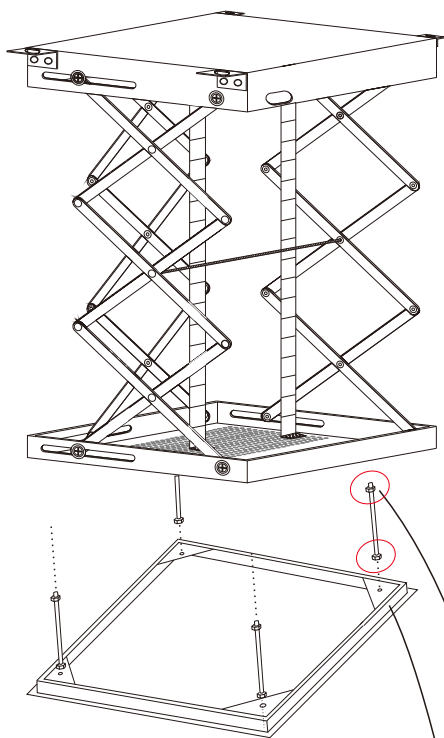

Step 11

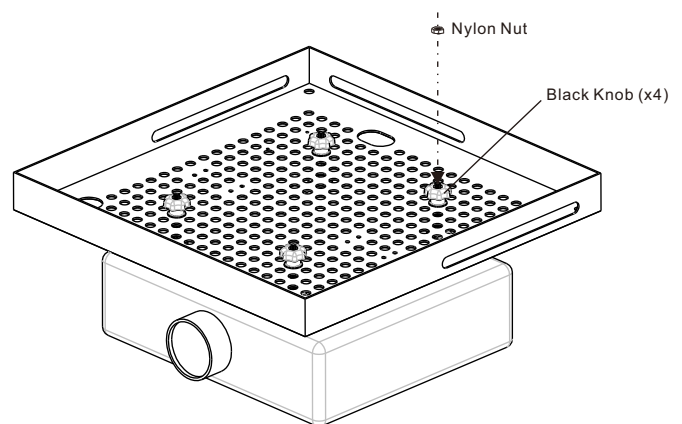

Step 12

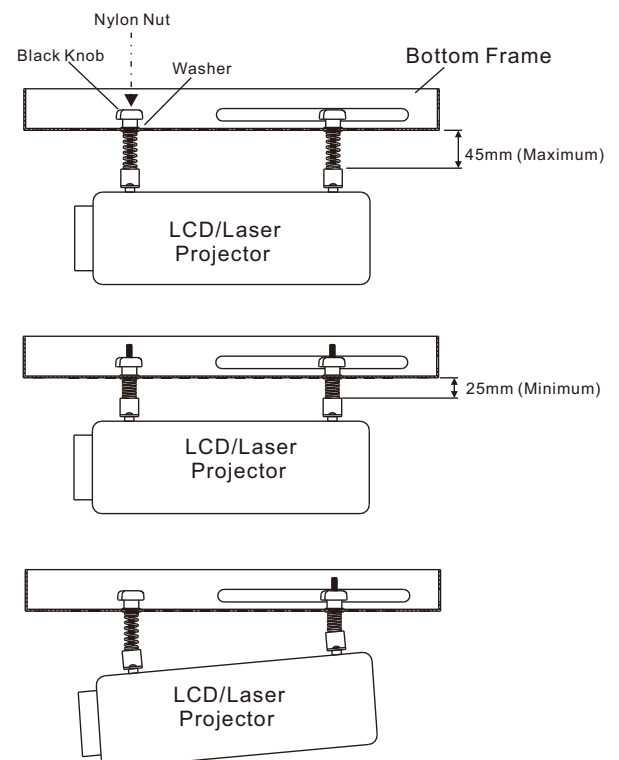

M8
Threaded
Rod

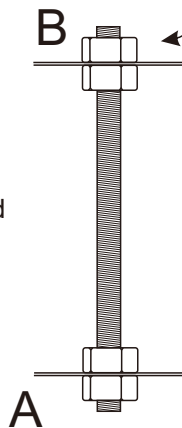

End